

[REDACTED]

Legal Description of Property [REDACTED]

A PARCEL OF LAND LOCATED IN THE NORTHWEST QUARTER OF SECTION 1, TOWNSHIP 1 SOUTH, RANGE 66 WEST OF THE 6TH PRINCIPAL MERIDIAN; COUNTY OF ADAMS, STATE OF COLORADO; BEING MORE PARTICULARLY DESCRIBED AS FOLLOWS:

COMMENCING AT THE NORTHWEST CORNER OF SAID SECTION 1, FROM WHICH THE WEST QUARTER CORNER OF SAID SECTION 1 BEARS SOUTH 00°46'49" EAST, A DISTANCE OF 2331.28 FEET;

THENCE SOUTH 00°46'49" EAST, ALONG THE WEST LINE OF SAID NORTHWEST QUARTER, A DISTANCE OF 30.00 FEET TO THE **POINT OF BEGINNING**, BEING A POINT ON THE SOUTHERLY RIGHT-OF-WAY OF EAST 168TH AVENUE;

THENCE NORTH 89°59'06" EAST, ALONG SAID SOUTHERLY RIGHT-OF-WAY, A DISTANCE OF 1986.07 FEET TO THE NORTHWEST CORNER OF THAT PARCEL OF LAND DESCRIBED IN THE DOCUMENT RECORDED UNDER RECEPTION NUMBER 2018000042434 IN THE RECORDS OF THE ADAMS COUNTY CLERK AND RECORDER;

THENCE, ALONG THE WESTERLY BOUNDARY OF SAID PARCEL, THE FOLLOWING TWO (2) COURSES;

1. SOUTH 45°04'05" WEST, A DISTANCE OF 356.74 FEET;
2. SOUTH 24°18'10" WEST, A DISTANCE OF 1528.55 FEET TO THE SOUTHWEST CORNER OF SAID PARCEL OF LAND DESCRIBED IN THE DOCUMENT RECORDED UNDER RECEPTION NUMBER 2018000042434;

THENCE CONTINUING SOUTH 24°18'10" WEST, A DISTANCE OF 716.67 FEET TO A POINT ON THE EAST-WEST CENTERLINE OF SAID SECTION 1;

THENCE SOUTH 89°45'04" WEST, ALONG SAID CENTERLINE, A DISTANCE OF 778.15 FEET TO THE WEST QUARTER CORNER OF SAID SECTION 1;

THENCE NORTH 00°46'49" WEST, ALONG THE WEST LINE OF THE NORTHWEST QUARTER OF SAID SECTION 1, A DISTANCE OF 2301.28 FEET TO THE **POINT OF BEGINNING**.

CONTAINING AN AREA OF 69.680 ACRES, (3,035,251 SQUARE FEET), MORE OR LESS.

EXHIBIT ATTACHED AND MADE A PART HEREOF.

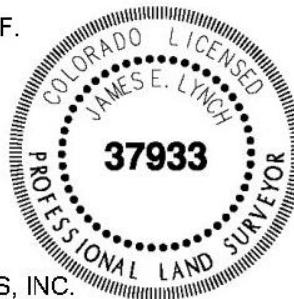

JAMES E. LYNCH, PLS NO. 37933
FOR AND ON BEHALF OF AZTEC CONSULTANTS, INC.
300 E. MINERAL AVE., SUITE 1, LITTLETON, CO 80122
303-713-1898